

RODAMIENTOS DE AGUJAS DE ANILLOS MAQUINADOS

SELLADO, SIN ANILLO INTERIOR

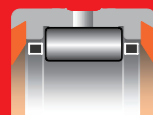

RNA49UU, RNA69UU ($F_w \leq 35$)



RNA69UU

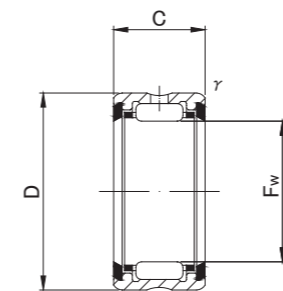

RNA49UU, RNA69UU ($F_w \leq 35$)

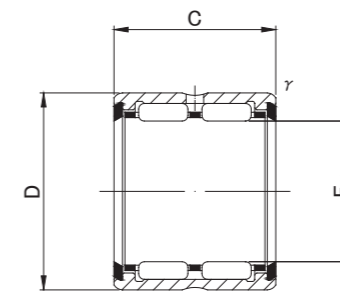

RNA69UU

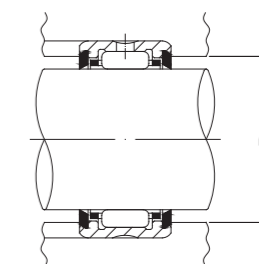

TIPO RNA49UU, RNA69UU, SELLADO

Grasa prerrellenada

Diámetro de eje (mm)	Designación		Dimensiones (mm)				Dimensiones de montaje estándar (mm)	Capacidad de carga dinámica básica	Capacidad de carga estática básica	Velocidad límite (GRASA)	Masa	Designación de rodamiento utilizable	
	RNA 49UU	RNA 69UU	F_w	D	C	r_s mín.	D_a MÁX.	Cr N	Cor N	rpm	g (aprox.)	ANILLO INTERIOR	CON ANILLO INTERIOR
14	RNA 4900UU	—	14 $\begin{smallmatrix} +0.027 \\ +0.016 \end{smallmatrix}$	22	13	0.3	20	8 000	8 500	14 000	16	IRZ101414	NA4900UU
16	RNA 4901UU	—	16 $\begin{smallmatrix} +0.027 \\ +0.016 \end{smallmatrix}$	24	13	0.3	22	8 400 15 600	9 300 20 400	12 000 12 000	18 30	IRZ121614 IRZ121623	NA4901UU NA6901UU
	—	RNA 6901UU	16 $\begin{smallmatrix} +0.027 \\ +0.016 \end{smallmatrix}$	24	22	0.3	22						
20	RNA 4902UU	—	20 $\begin{smallmatrix} +0.033 \\ +0.020 \end{smallmatrix}$	28	13	0.3	26	9 600 18 400	11 700 27 100	9 500 9 500	22 38	IRZ152014 IRZ152024	NA4902UU NA6902UU
	—	RNA 6902UU	20 $\begin{smallmatrix} +0.033 \\ +0.020 \end{smallmatrix}$	28	23	0.3	26						
22	RNA 4903UU	—	22 $\begin{smallmatrix} +0.033 \\ +0.020 \end{smallmatrix}$	30	13	0.3	28	10 300 19 800	13 100 30 600	8 500 8 500	23 40	IRZ172214 IRZ172224	NA4903UU NA6903UU
	—	RNA 6903UU	22 $\begin{smallmatrix} +0.033 \\ +0.020 \end{smallmatrix}$	30	23	0.3	28						
25	RNA 4904UU	—	25 $\begin{smallmatrix} +0.033 \\ +0.020 \end{smallmatrix}$	37	17	0.3	35	17 900 33 000	20 500 44 500	7 500 7 500	55 96	IRZ202518 IRZ202531	NA4904UU NA6904UU
	—	RNA 6904UU	25 $\begin{smallmatrix} +0.033 \\ +0.020 \end{smallmatrix}$	37	30	0.3	35						
30	RNA 4905UU	—	30 $\begin{smallmatrix} +0.033 \\ +0.020 \end{smallmatrix}$	42	17	0.3	40	20 300 39 200	25 100 58 600	6 500 6 500	63 110	IRZ253018 IRZ253031	NA4905UU NA6905UU
	—	RNA 6905UU	30 $\begin{smallmatrix} +0.033 \\ +0.020 \end{smallmatrix}$	42	30	0.3	40						
35	RNA 4906UU	—	35 $\begin{smallmatrix} +0.041 \\ +0.025 \end{smallmatrix}$	47	17	0.3	45	21 600 40 100	28 400 63 100	5 500 5 500	71 130	IRZ303518 IRZ303531	NA4906UU NA6906UU
	—	RNA 6906UU	35 $\begin{smallmatrix} +0.041 \\ +0.025 \end{smallmatrix}$	47	30	0.3	45						
42	RNA 4907UU	—	42 $\begin{smallmatrix} +0.041 \\ +0.025 \end{smallmatrix}$	55	20	0.6	51	30 100 51 600	46 300 92 600	4 500 4 500	110 200	IRZ354221 IRZ354237	NA4907UU NA6907UU
	—	RNA 6907UU	42 $\begin{smallmatrix} +0.041 \\ +0.025 \end{smallmatrix}$	55	36	0.6	51						
48	RNA 4908UU	—	48 $\begin{smallmatrix} +0.041 \\ +0.025 \end{smallmatrix}$	62	22	0.6	58	37 200 63 700	58 300 116 700	4 000 4 000	150 270	IRZ404823 IRZ404841	NA4908UU NA6908UU
	—	RNA 6908UU	48 $\begin{smallmatrix} +0.041 \\ +0.025 \end{smallmatrix}$	62	40	0.6	58						
52	RNA 4909UU	—	52 $\begin{smallmatrix} +0.049 \\ +0.030 \end{smallmatrix}$	68	22	0.6	64	38 800 66 700	63 400 126 500	3 500 3 500	190 355	IRZ455223 IRZ455241	NA4909UU NA6909UU
	—	RNA 6909UU	52 $\begin{smallmatrix} +0.049 \\ +0.030 \end{smallmatrix}$	68	40	0.6	64						
58	RNA 4910UU	—	58 $\begin{smallmatrix} +0.049 \\ +0.030 \end{smallmatrix}$	72	22	0.6	68	41 300 70 800	71 100 142 200	3 500 3 500	180 320	IRZ505823 IRZ505841	NA4910UU NA6910UU
	—	RNA 6910UU	58 $\begin{smallmatrix} +0.049 \\ +0.030 \end{smallmatrix}$	72	40	0.6	68						